

# SHIELD

with Mechanical Channel

## Installation instructions

935003 – 09-2020

| EN |

dormakaba 

# Table of contents

<b>1</b>	<b>Technical specifications</b>	<b>3</b>
1.1	Overview	3
	1.1.1 General information	3
	1.1.2 Intended use	3
	1.1.3 Glass requirements/fittings/mounting	3
	1.1.4 Requirements for glass panel	3
	1.1.5 Safety instructions	3
	1.1.6 Symbols used - Safety/Installation	3
	1.1.7 Maintenance, care, repair	3
	1.1.8 Disposal	3
<b>2</b>	<b>Installation instructions</b>	<b>4</b>
2.1	Overall	4
2.2	Secure channel base to mounting surface	4
2.3	Install clamp brackets	5
2.4	Install covers and end caps	5

# 1 Technical specifications

## 1.1 Overview

These instructions are for installation of SHIELD with Mechanical Channel for the following mounting and style versions:

### 1. Glass mounting

#### 1.1.1 General information

- dormakaba requires use of tempered monolithic glass only for this product.
- dormakaba glass hardware is not suitable for harsh environment; for example, applications where chemicals (e.g. chlorine) are used such as indoor swimming pools, saunas, or salt-water pools.

#### 1.1.2 Intended use

- For stationary glass panels in dry indoor areas only.

#### 1.1.3 Glass requirements/fittings/mounting

- The substructure/wall must be able to bear permanent loads, and be level (max. tolerance: 1/16" [2] per 39" [1m]).
- Fasteners must be sufficiently dimensioned for the substructure/wall and weight of the glass.
- When adjusting glass elements, always stick to the required clearance for the respective hardware. Adjust clearance so glass does not come in contact with any hard surfaces such as glass, metal or concrete.
- Do not use excessive force when installing the glass (avoid over tightening screws.)

#### 1.1.4 Requirements for glass panel

- dormakaba requires use of fully tempered glass, which complies with ASTM C 1036 and ASTM C 1048. Secondary heat soaking processes are optional but not required.
- Clamping area must be flat and uncoated (no self-cleaning coating!)
- Never use glass with conchoidal fractures and/or damaged edges.

#### 1.1.5 Safety instructions

- Installation requires two people.
- Always wear protective clothing.
- Only properly qualified and specially trained staff is authorized to mount dormakaba glass hardware.

- Due to crushing hazards and possible injury caused by breakage of glass during mounting, corresponding protective clothing (especially gloves and protective goggles) is required.



- Never clamp metal glass fitting hardware directly to glass surface.

#### 1.1.6 Symbols used - Safety/Installation

##### CAUTION



Mounting components must meet the requirements of substructure/wall and door weight. Please read the technical information for fittings.

##### WARNING



Risk of breaking glass. When installing the door, support the door panel with a block of wood or similar object.



##### CLOSING EDGE OF DOOR

#### 1.1.7 Maintenance, care, repair

- Immediately replace damaged parts.
- Always use original dormakaba parts.
- Clean clamping area with alcohol-based standard commercial cleaning agent before mounting the glass hardware.
- Use a damp cloth for occasional cleaning.
- Always use silicone - and oil-free cleaners (e.g. acetone).
- Check glass hardware at regular intervals for proper positioning, smooth operation and correct adjustment.
- High traffic systems require inspection by properly qualified staff (specialized companies or installation firms.)
- Function of fittings is recommended to be checked every 500,000 movements by a specialist.

#### 1.1.8 Disposal

Disposal in accordance with local, state and national regulations.

## 2 Installation instructions

### 2.1 Overall

Fig.1

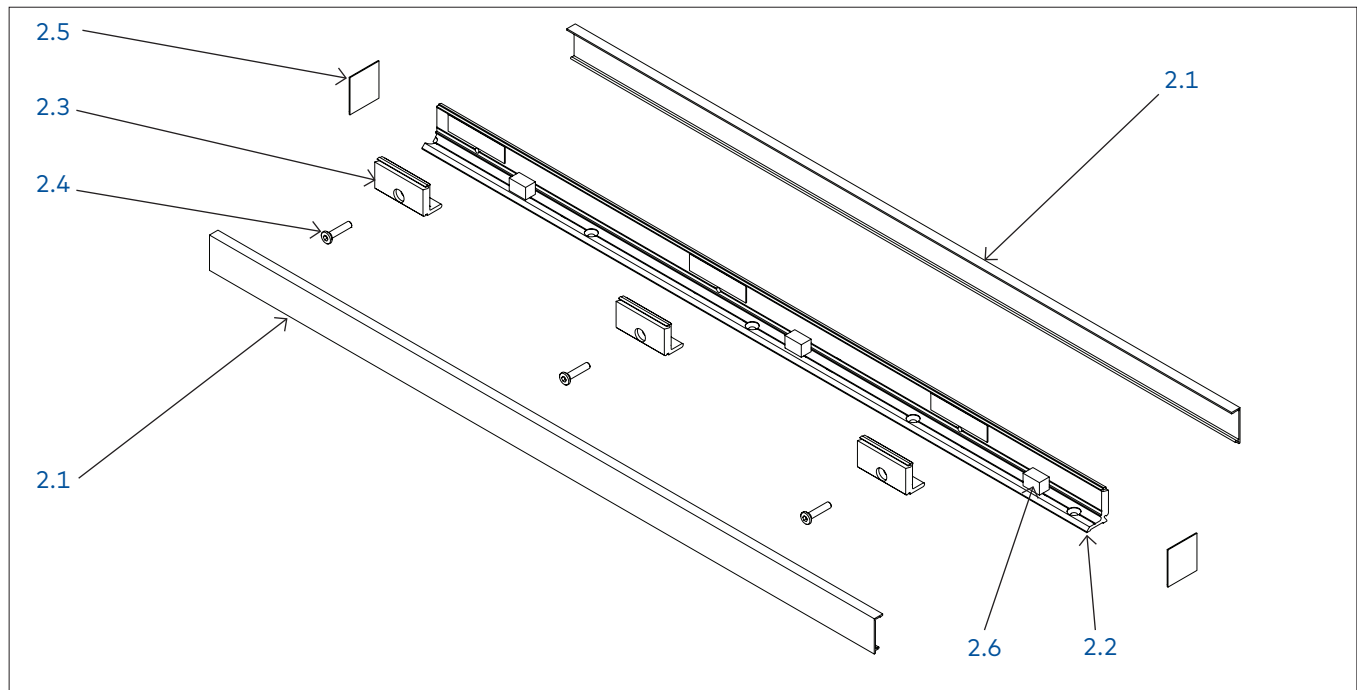

2.1 Covers

2.2 Channel base

2.3 Channel clamp brackets

2.4 Clamp bracket fasteners

2.5 End caps (x2)

2.6 Setting blocks

### 2.2 Secure channel base to mounting surface

Fig.2

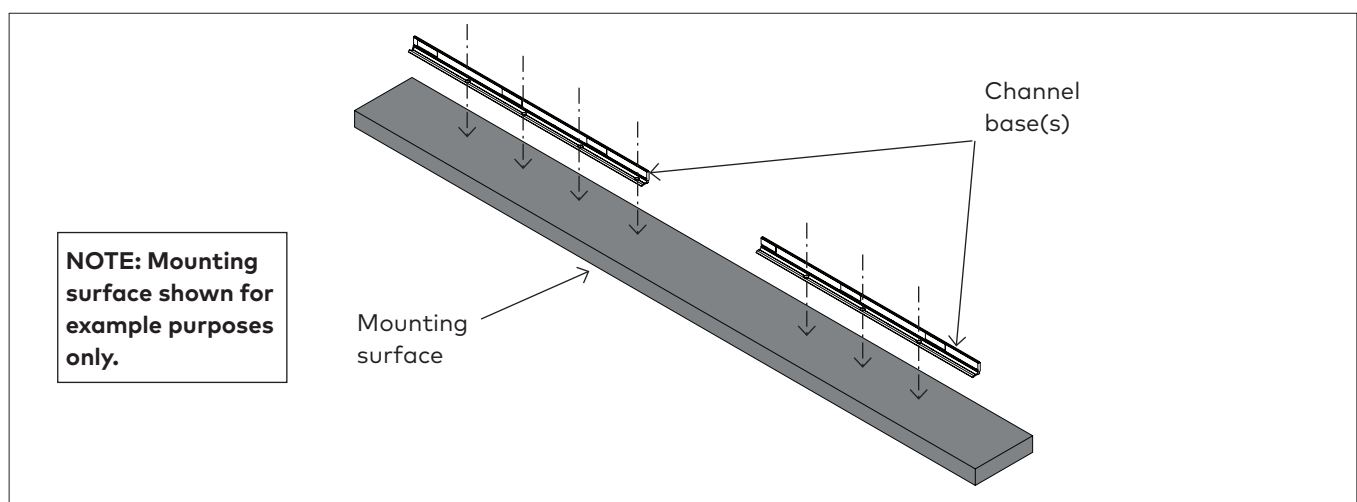

2.2.1 Utilize 36" channel length or cut to appropriate length(s) required.

**NOTE: Extrusions may be cut in the field to meet the application's specific needs/requirements. Please note that dormakaba is not responsible for material cut incorrectly.**

2.2.1 Secure channel base(s) to mounting surface.

- Use appropriate fasteners relative to mounting surface material.

## 2.3 Install clamp brackets

Fig.3

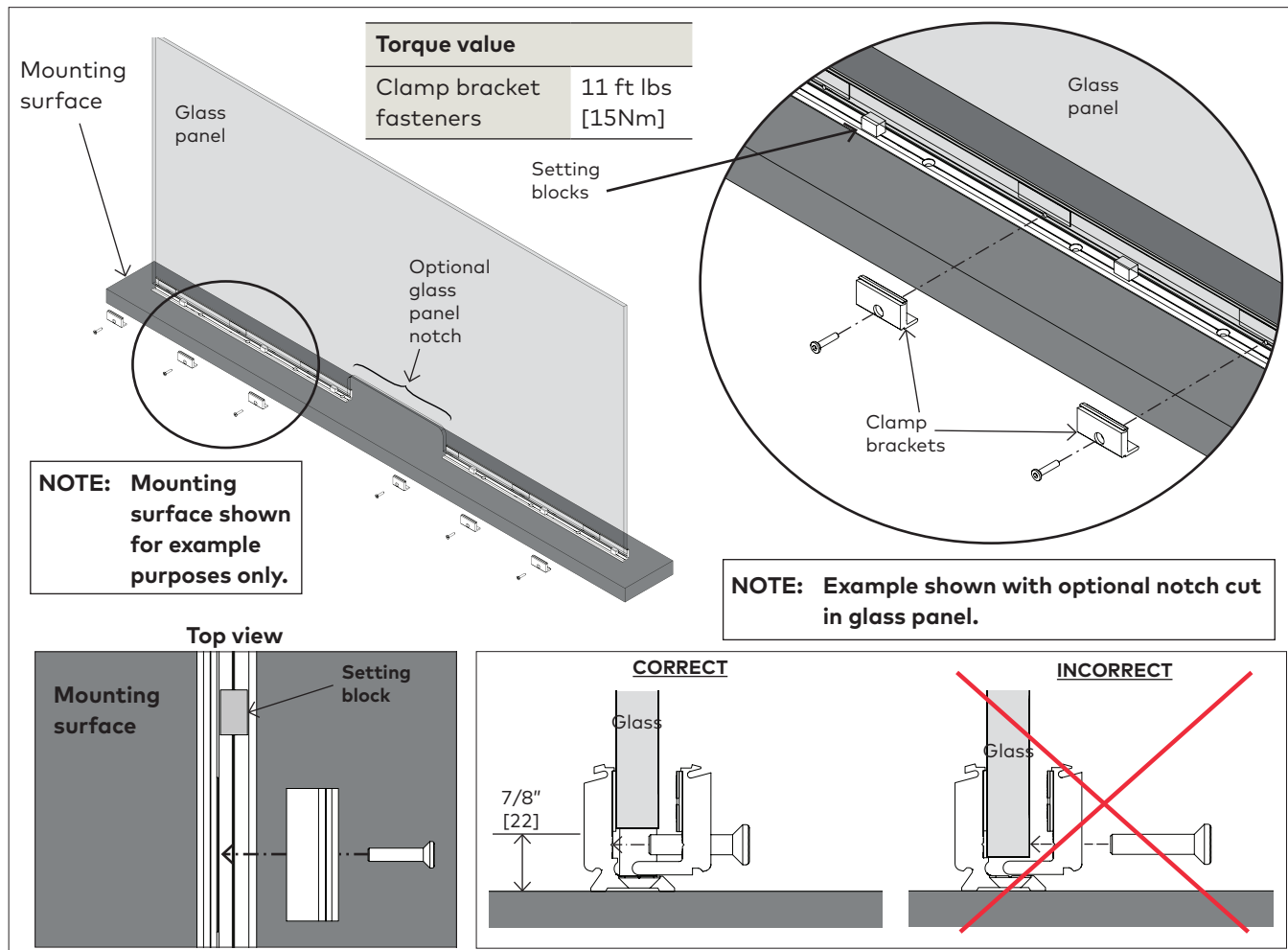

2.3.3 Insert setting blocks into channel base(s).

**NOTE:** Ensure blocks do not interfere with fasteners. See "top view" image above.

**NOTE:** Ensure a minimum 7/8" [22] gap between bottom of glass panel and mounting surface to allow clearance for the fasteners. See "CORRECT" image noted above.

2.3.4 Set glass panel onto setting blocks in channel base(s).

2.3.5 Secure clamp brackets to channel base(s).

- **Glass panel with notch:** Use minimum of 2 clamps on either side of glass panel notch. Use provided fasteners.
- **Glass panel without notch:** Use 1 clamp at each predrilled hole in channel. Use provided fasteners.
- Tighten at 11 ft lbs [15Nm].

## 2.4 Install covers and end caps

Fig.4

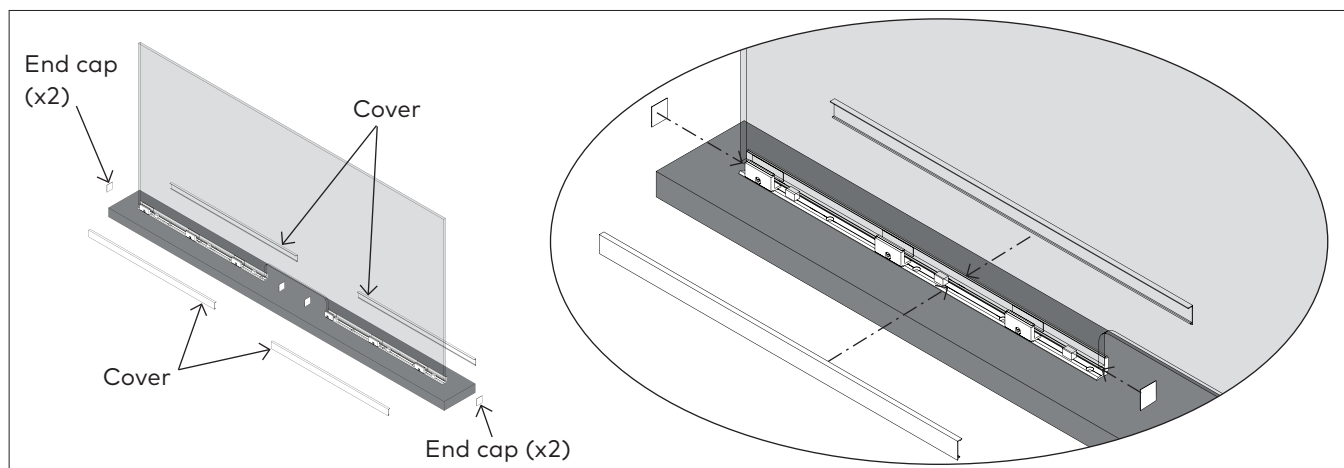

2.4.1 Snap cover(s) and end caps into place.

